

# **TERUMO**<sup>®</sup>

## Product Catalog

Blood Pressure Monitor · Conventional Syringes · I.V. Catheters · Micro-Collection Products · Conventional Needles · Safety Products · Winged Infusion Sets



# Table of Contents

## Blood Pressure Monitor

Elemano® Blood Pressure Monitor 3

## Hypodermics

SurGuard®3 Safety Hypodermic Needle 4-5

SurGuard®2 Safety Needles 6

SurGuard®2 Syringes with Safety Needle 6

Terumo Hypodermic Syringes 7

Terumo Hypodermic Needles 7

SurSaver® 1CC Syringe with Low Dead Space 7

## Insulin & Allergy Syringes

Terumo Standard Insulin Syringes 8

Terumo Standard Allergy Syringes & Allergy Trays 8

SurSaver® Mixing Syringes 8

## Micro-collection

Surshield® Safety Blood Collection Sets 9

Venoject® Tube Holder 9

Multi-Sample Luer Adapter 9

Capiject® Safety Lancets 10

Capiject® Capillary Tubes 10

## Winged Infusion Needle Sets

SURFLO® Winged Infusion Sets 11

Surshield® Safety Winged Infusion Sets 11

## Safety IV Catheters

SurFlash® Safety IV Catheters 13

## IV Catheters & Accessories

SURFLO® ETFE I.V. Catheters 14

SurFlash® Polyurethane I.V. Catheters 14

SURFLO® Injection Plugs 14



## Blood Pressure Monitor

XS/S/M/L cuffs available

# Elemano®

Portable Blood Pressure Monitor with PrecisePulse™ Technology

### So accurate. So easy.

The ONLY professional-grade blood pressure device on the market that offers “Gold Standard Accuracy” and PrecisePulse™ Technology right in the palm of your hand. Built-in PrecisePulse™ Technology provides clearer distinctions of K-sounds than conventional auditory means.



- Simultaneous BP and Pulse readout in only 30 seconds
- Gold Standard Accuracy to within 3 mmHg
- Rugged and durable in drop test studies\*
- No calibration EVER required
- No stethoscope required
- Compact, portable, and lightweight (only 10 ounces)
- Suitable for use with pediatric patients ages 3 and above
- Mercury-free device



### Specifications

<b>Measurement method</b>	Oscillometric (double cuff supported)	<b>Power supply</b>	Voltage: 1.5 V DC or 1.2 V DC
<b>Displayed measurements</b>	Systolic blood pressure, diastolic blood pressure, pulse rate (pulse waves)	<b>Operating conditions</b>	Temperature: 10 - 40°C; Humidity: 15 - 90% RH (no condensation)
<b>Measurement range</b>	Pressure: 0 - 320 mmHg (0 - 42.7kPa) Pulse rate: 30 - 199 beats/min	<b>Storage conditions</b>	Temperature: -20 - 60°C; Humidity: 10 - 95% RH (no condensation)
<b>Accuracy</b>	Pressure: ± 3 mmHg (± 0.4kPa) Pulse rate: ± 5	<b>Dimensions</b>	Main body: (w) 70 mm x (h) 46 mm x (d) 169 mm Cuff (size M): (w) 150 mm x (l) 520 mm
<b>Pressurization method</b>	Manual	<b>Weight</b>	Main body: 130g (excluding the battery) Cuff (size M): Approx. 150 g
<b>Decompression method</b>	Automatic	<b>Validation</b>	The Elemano was tested on 87 persons to compare its accuracy with that of the auscultatory method according to the AAMI SP-10 protocol. <sup>(1)</sup> The results prove that the Elemano fulfills the AAMI criteria.
<b>Measurement area</b>	Upper arm		
<b>Warnings</b>	Insufficient and excessive pressurization, low battery		
<b>Errors</b>	Relevant error codes are displayed (Please consult IFU)		
<b>Automatic power off</b>	After 3 minutes without input on the operation panel		
<b>Number of measurements</b>	Provides about 1,000 measurements with a new AA alkaline cell when used continuously in the Normal Mode. (Refer to IFU)		

*References: (1) Accuracy and applicability of the Terumo ES-H55 double-cuff sphygmomanometer for hospital use. Osamu Tochikubo, Kiyoko Nishijima, Kenji Ohshige and Kazuo Kimura - Blood Pressure Monitoring 2003, 8:203-209*

### Blood pressure monitor and accessories

To enable the right choice of cuff size and meet the hygiene requirements of a medical environment, Terumo offers a washable nylon cuff cover and four sizes (XS,S,M,L) to meet those requirements.

Product	Product Code
<b>Elemano blood pressure monitor</b> (includes Monitor, M-size nylon cuff, 2xbatteries, IFU)	ES*H5503
<b>Cuff</b> (washable nylon cuff cover plus air bag and tubing)	
Extra Small 13-20 cm (arm circumference)	XX*ES11SS06
Small 17-26 cm (arm circumference)	XX*ES11S06
Medium 24-32 cm (arm circumference)	XX*ES11M06
Large 32-42 cm (arm circumference)	XX*ES11L06

Product	Product Code
<b>Cuff Cover</b> (washable nylon cuff cover)	
Extra Small 13-20 cm (arm circumference)	XX*ES14SS06
Small 17-26 cm (arm circumference)	XX*ES14S06
Medium 24-32 cm (arm circumference)	XX*ES14M06
Large 32-42 cm (arm circumference)	XX*ES14L06
<b>Inflation bulb</b>	XX*ES1802
<b>Storage bag</b>	XX*ES1702
<b>Accuracy check parts</b>	XX*ES1602

\* Data on file.

# Pick how you click.



With 3 ways to activate and a broader range of sizes than most other brands, SurGuard®3 is the industry's most adaptable safety needle. Add separate thumb and finger grips, unequalled sharpness, and competitive pricing, and you'll understand why we say SurGuard®3 is the one needle that fits *every* clinician's style.

- 3 modes of activation—thumb, finger, or hard surface
- Separate finger/thumb grips with ridges and nonslip surfaces
- Hub and needle locks for security post activation
- Broad range of sizes
- Firm injection feel
- Sharpest needles among major brands tested\*
  - 10% sharper than similar needles from Becton, Dickinson and Company
  - More comfortable injections for patients

**Bottom line:** No matter what you're looking for in a needle, you're looking for SurGuard®3.

\*Reference: Data on file. Terumo Medical Products, April 2009.



# Order the industry's most adaptable safety needle today!

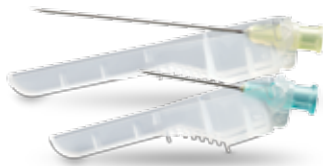

Order No.	Description
SG3-1825	18G x 1" needle
SG3-1838	18G x 1 1/2" needle
SG3-2025	20G x 1" needle
SG3-2038	20G x 1 1/2" needle
SG3-2051	20G x 2" needle
SG3-2125	21G x 1" needle
SG3-2138	21G x 1 1/2" needle
SG3-2225	22G x 1" needle
SG3-2238	22G x 1 1/2" needle
SG3-2325	23G x 1" needle
SG3-2338	23G x 1 1/2" needle
SG3-2516	25G x 5/8" needle
SG3-2525	25G x 1" needle
SG3-2538	25G x 1 1/2" needle
SG3-2713	27G x 1/2" needle
SG3-3013	30G x 1/2" needle

Order No.	Description
SG3-01T2516	1CC Syringe with 25G x 5/8" needle
SG3-01T2713	1CC Syringe with 27G x 1/2" needle
SG3-03L2025	3CC Syringe with 20G x 1" needle
SG3-03L2038	3CC Syringe with 20G x 1 1/2" needle
SG3-03L2125	3CC Syringe with 21G x 1" needle
SG3-03L2138	3CC Syringe with 21G x 1 1/2" needle
SG3-03L2225	3CC Syringe with 22G x 1" needle
SG3-03L2238	3CC Syringe with 22G x 1 1/2" needle
SG3-03L2325	3CC Syringe with 23G x 1" needle
SG3-03L2516	3CC Syringe with 25G x 5/8" needle
SG3-03L2525	3CC Syringe with 25G x 1" needle



You know what you like.  
And *whatever* your preference,  
you'll find it in SurGuard®3!



**SurGuard®3**  
SAFETY HYPODERMIC NEEDLE

## Safety Hypodermics

Terumo® is a worldwide leader in the design, manufacture, and marketing of hypodermic syringes and needles.

- Unique needle locking mechanism to help reduce the risk of needlestick injury
- An audible click\* indicates device activation
- One-handed activation for ease of use
- Sleek, thin, streamlined sheath
- Bevel-up, sheath right orientation, especially useful for low-angle injections
- Ratchet mechanism, allows for precise positioning of sheath so as not to obscure injection site
- Standard hub fits all luer lock and luer slip syringes

\* NOTE: Audible click may not be heard on small needle sizes; visual confirmation is required.

These products have no components made of natural rubber latex.



(Large Photo)



### SurGuard®2 Syringe with Safety Needle

Packed: 100/box, 4 boxes/case (400)

### SurGuard®2 Safety Needle

Packed: 100/box, 8 boxes/case (800)

Product Code	Description
SG2-1825	18G x 1" needle
SG2-1838	18G x 1½" needle
SG2-1925	19G x 1" needle
SG2-1938	19G x 1½" needle
SG2-2025	20G x 1" needle
SG2-2038	20G x 1½" needle
SG2-2125	21G x 1" needle
SG2-2138	21G x 1½" needle
SG2-2225	22G x 1" needle
SG2-2238	22G x 1½" needle
SG2-2325	23G x 1" needle
SG2-2338	23G x 1½" needle
SG2-2516	25G x 5/8" needle
SG2-2525	25G x 1" needle
SG2-2538	25G x 1½" needle
SG2-2613	26G x 1/2" needle
SG2-2713	27G x 1/2" needle
SG2-3013	30G x 1/2" needle

#### 1CC Syringes

Product Code	Description
SG2-01T2516	25G x 5/8" needle
SG2-01T2609	26G x 3/8" needle
SG2-01T2713	27G x 1/2" needle

#### 3CC Syringes

Product Code	Description
SG2-03L2025	20G x 1" needle
SG2-03L2038	20G x 1½" needle
SG2-03L2125	21G x 1" needle
SG2-03L2138	21G x 1½" needle
SG2-03L2225	22G x 1" needle
SG2-03L2238	22G x 1½" needle
SG2-03L2325	23G x 1" needle
SG2-03L2516	25G x 5/8" needle
SG2-03L2525	25G x 1" needle

#### 5CC Syringes

Product Code	Description
SG2-05L2025	20G x 1" needle
SG2-05L2038	20G x 1½" needle
SG2-05L2138	21G x 1½" needle

#### 10CC Syringes

Product Code	Description
SG2-10L2025	20G x 1" needle
SG2-10L2038	20G x 1½" needle
SG2-10L2125	21G x 1" needle

## Conventional Hypodermics



### Terumo® Standard Hypodermic Needles

Packed: 100/box, 10 boxes/case (1,000)

Product Code	Description
■ NN-2713R	27G x 1/2" RW
■ NN-2732R	27G x 1 1/4" RW
■ NN-3013R	30G x 1/2" RW
■ NN-3025R	30G x 1" RW



Luer Lock Tip

### 3cc Syringes with Needle

Style: Luer Lock Tip

Graduations: 0.1cc (3cc total)

Packed: 100/box, 10 boxes/case (1,000)

Product Code	Description
SS-03L2138	3cc, 21G x 1 1/2" UTW



### SurSaver® 1CC Syringe with Low Dead Space

SurSaver® 1CC syringes are designed with a permanently attached needle which eliminates the needle hub. This design greatly reduces dead space as compared to standard syringes. The needle hub on standard syringes traps drugs that are not expelled after injection. Over the course of one year, these accumulated, "wasted" drugs can represent a significant cost to your facility.

1cc syringe with fixed needle

Packed: 100/box, 5 boxes/case (500)

Product Code	Description
SS01D2313	23G x 1/2"
SS01D2516	25G x 5/8"
SS01D2713	27G x 1/2"

RW - Regular Wall  
 TW - Thin Wall  
 UTW - Ultra Thin Wall

## Insulin and Allergy Products

### Terumo Standard Insulin Syringes

Low Dead Space design, for use with U-100 insulin only, with attached needle. Based on extreme needle sharpness and smooth plunger movement, TERUMO® Insulin syringes are designed for maximum comfort. Clear, bold scale markings assure dosage control and accuracy.

**Packed: 100/box, 5 boxes/case (500)**

Product Code	Description (All Insulin Syringe)
SS05M2713	1/2 cc, 27G x 1/2" Graduations: 0.01cc, 1 unit of insulin
SS05M2813	1/2 cc, 28G x 1/2" Graduations: 0.01cc, 1 unit of insulin
SS05M2913	1/2 cc, 29G x 1/2" Graduations: 0.01cc, 1 unit of insulin
SS05M3009	1/2 cc, 30G x 3/8" Graduations: 0.01cc, 1 unit of insulin
SS05M3109	1/2 cc, 31G x 3/8" Graduations: 0.01cc, 1 unit of insulin
SS10M2713	1 cc, 27G x 1/2" Graduations: 0.02cc, 2 units of insulin
SS10M2813	1 cc, 28G x 1/2" Graduations: 0.02cc, 2 units of insulin
SS10M2913	1 cc, 29G x 1/2" attached needle, Graduations: 0.02cc, 2 units of insulin
SS10M3009	1 cc, 30G x 3/8" attached needle, Graduations: 0.01cc, 1 unit of insulin
SS10M3109	1 cc, 31G x 3/8" attached needle, Graduations: 0.02cc, 2 units of insulin
SS30M2913	3/40 cc, 29G x 1/2" attached needle, Graduations: 0.01cc, 1 unit of insulin
SS30M3009	3/40 cc, 30G x 3/8" attached needle, Graduations: 0.01cc, 1 unit of insulin
SS30M3109	3/40 cc, 31G x 3/8" attached needle, Graduations: 0.005cc, 1/2 unit of insulin



### Terumo Standard Allergy Trays & Allergy Syringes

TERUMO Allergy Syringes are packaged in trays of 25 pieces and have low dead space for maximum cost savings. The barrel is clear and easy to read. Sharp needles minimize patient discomfort.

**Allergy Syringe Trays Packed: 25 syringes/tray, 40 trays/case (1,000)**

Product Code	Description
SS01A2609T	1cc with 26G x 3/8" regular bevel needle
SS01A2713T	1cc with 27G x 1/2" regular bevel needle
SS10A2709IDT	1cc with 27G x 3/8" intradermal bevel needle for skin testing
SS10A2713IDT	1cc with 27G x 1/2" intradermal bevel needle for skin testing

**Allergy Syringes Packed: 100/box, 5 boxes/case (500)**

SS01A2713	1cc Single Allergy Syringe with 27G x 1/2" regular bevel needle, individually packed, Graduations: 0.01cc (1cc total)
-----------	-----------------------------------------------------------------------------------------------------------------------



### SurSaver® Mixing Syringes:

- Easy to draw up viscous allergenic extracts
- Only 0.0021 mL dead space minimizes antigen waste
- Smooth plunger
- Clear barrel
- Easy to read scale markings
- Ultra-sharp needle

### SurSaver® Mixing Syringe Trays

**Packed: 25/tray, 40 trays/case (1,000)**

Product Code	Description
SS01A2313T	1cc with 23G x 1/2" regular bevel needle, tray



### SurSaver® Mixing Syringes Individually Packed

**Packed: 100/box, 5 boxes/case (500)**

Product Code	Description
SS01D2313	1cc with 23G x 1/2" regular bevel needle, individually packed



These products have no components made of natural rubber latex.





(Large Photo)

## Surshield® Safety Winged Blood Collection Sets

Packed: 50/box, 10 boxes/case (500)



### Product Code Description

#### (12" Tubing)

MN*SVS21B30	21G x 3/4" needle
MN*SVS23B30	23G x 3/4" needle
MN*SVS25B30	25G x 3/4" needle

#### (7" Tubing)

MN*SVS21B18	21G x 3/4" needle
MN*SVS23B18	23G x 3/4" needle

These products have no components made of natural rubber latex.

## Venject® Tube Holder

Standard Tube Holder compatible with most blood collection needles.

Packed: 50/bag, 20 bags/case (1,000)

### Product Code Description

P-1316R	VENOJECT II (Standard) Tube Holder. Use with the multi-sample luer adapter and Diversion Blood Sampling Arm® and Blood Sampling Arm blood bags to collect samples.
---------	--------------------------------------------------------------------------------------------------------------------------------------------------------------------



## Multi-Sample Luer Adapter

Sterile and disposable, adapters fit into standard infusion sets transforming them into winged blood collection sets. This allows multiple draws into evacuated tubes. Accepts standard tube holders.

Packed: 100/box, 30 boxes/case (3,000)

### Product Code Description

MN*2000T	VENOJECT® Multi-Sample Luer Adapter (male). For use with Standard Tube Holder and SampLok® Tube Holder.
----------	---------------------------------------------------------------------------------------------------------



## Blood Collection Sets

# Safety

Terumo's Surshield Safety Winged Needle Sets with one-handed activation provides a solution with a cost-effective, easy to use design. Press shield over the needle until it locks into place.

- Unique needle locking mechanism helps reduce the risk of needlestick injuries
- One-handed activation for safety and ease of use
- No change in needle insertion technique
- Simple, built-in safety design is easy to use

1. Flip safety shield toward needle. Remove the needle and apply digital pressure to the site.

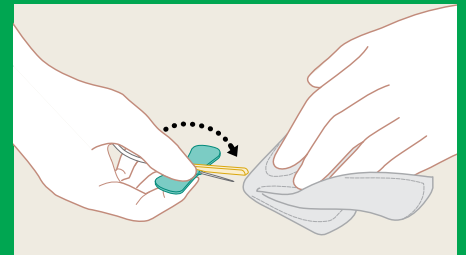

2. With the wing and shield between your thumb and index finger, press the safety shield against a hard surface such as a bedside table until an audible click is heard.

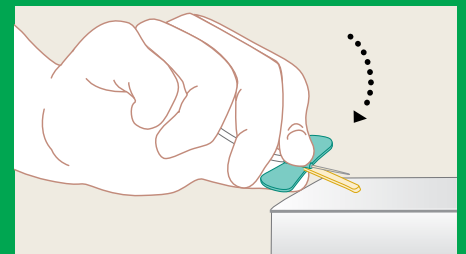

3. Visually confirm activation of the safety feature. (10/08)



## Micro-collection

### Capiject Safety Lancets

High quality, single-use lancets offer the form, fit and function you've come to rely on

- **Never see or handle the sharp:**  
Automatic blade or needle retraction styles - the sharp edge is enclosed before and after use
- **No special staging required:**  
Ready to use right out of the box
- **One-step activation:**  
Convenient activation for precise and consistent results
- **Color-coded sizes:**  
Quick identification of the right product

**Packed: 200/box, 10 boxes/case (2,000)**



Catalog Number	Color	Description	Width/Gauge	Depth
200101	Pink	Blade	1.5mm	1.0mm
200102	Green	Blade	1.5mm	1.5mm
200103	Blue	Blade	1.5mm	2.0mm
200104	Orange	Needle	23G	2.25mm
200105	Purple	Needle	28G	1.25mm



“Capiject® is preferred by our specimen collectors, is a better fit for our centrifuges and gives us quality plasma separation in an amber tube.”

— James E. Dillard, BS, MT(ASCP)  
Supervisor, Clinical Chemistry

### Capiject Capillary Tubes

- Extra-wide, built-in collection lip for enhanced specimen flow
- Single piece, tapered design for easy collection and handling
- Color-coded fill lines and caps for volume accuracy and easy identification
- Lot number and expiration date printed on each tube for easy identification
- Silicone-coated anticoagulant tubes designed to reduce clotting
- Olefin-based gel for clean separations
- Tube nests in cap allowing tube to stand alone
- Certified for lead testing
- These products have no components made of natural rubber latex.

**Packed: 50/bag, 5 bags/box, 4 boxes/case (1,000)**

FOR IN VITRO DIAGNOSTIC USE

Catalog Number	Tube Color	Tube additive	Application	Lead Testing Certified	Fill Volume $\mu\text{L}$
T-MG	Cherry Red	Gel Barrier with clot activator (silica particles and inert gel)	Serum determinations in clinical chemistry	X	500
T-MQK	Lavender	K2-EDTA (0.78 mg)	Whole blood hematology procedure	X	500
T-M	Brick Red	No Additive/Clot Tube	Serum determinations in clinical chemistry, serology and blood banking	X	500
T-MLH	Green	Lithium Heparin (12.5 IU)	Plasma determinations in clinical chemistry	X	500
T-MLHG	Mint Green	Lithium Heparin with Gel (12.5 IU)	Plasma determinations in clinical chemistry	X	500
T-MLHGA	Mint Green	Amber tube with Lithium Heparin and gel barrier (12.5 IU)	Light-sensitive plasma determinations in clinical chemistry	X	500
T-MPS	Gray	Sodium Fluoride (0.72 mg) Potassium Oxalate (0.58 mg)	Glucose determinations	X	250
T-MGA	Gold	Amber tube with gel barrier and clot activator (silica particles and inert gel)	Light-sensitive serum analyte determinations (Bilirubin determinations)	X	500

## Winged Infusion Sets

“Surshield® has been a great product for us. The Surshield is easy to use – you simply flip the shield over the needle.”

– Joe Barber  
Laboratory Manager

These products are DEHP-free and have no components made of natural rubber latex.



### SURFLO® Winged Infusion Sets

#### Product Code Description

##### (3½" Tubing)

Packed: 100/box, 5 boxes/case (500)

■ SV*19BLS	19G x ¾" TW
■ SV*21BLS	21G x ¾" UTW
■ SV*23BLS	23G x ¾" UTW
■ SV*25BLS	25G x ¾" TW

##### (8" Tubing)

Packed: 100/box, 10 boxes/case (1,000)

■ SV*25EL	25G x ½" RW
■ SV*27EL	27G x ½" RW

##### (12" Tubing)

Packed: 50/box, 10 boxes/case (500)

■ SV-18BLK	18G x ¾" TW
■ SV-19BLK	19G x ¾" TW
■ SV-21BLK	21G x ¾" UTW
■ SV-22BLK	22G x ¾" UTW
■ SV-23BLK	23G x ¾" UTW
■ SV-25BLK	25G x ¾" TW

### Surshield® Safety Winged Infusion Sets

Packed: 50/box, 10 boxes/case (500)

#### Product Code Description

##### (3½" Tubing)

■ SV*S19BLS	19G x ¾" needle
■ SV*S21BLS	21G x ¾" needle
■ SV*S23BLS	23G x ¾" needle
■ SV*S25BLS	25G x ¾" needle

##### (12" Tubing)

■ SV*S19BL	19G x ¾" needle
■ SV*S21BL	21G x ¾" needle
■ SV*S23BL	23G x ¾" needle
■ SV*S25BL	25G x ¾" needle



RW - Regular Wall  
TW - Thin Wall  
UTW - Ultra Thin Wall

# FLASH YOUR CONFIDENCE

With SurFlash® safety catheters—  
clinically proven to increase first-stick success by up to 25%<sup>1</sup>

## A better experience for you and your patients

- The only safety IV catheter with a double-flash feature that verifies both needle **and** catheter placement
  - Reduced risk of back vein wall puncture
  - Clinically proven to increase first-stick success
    - Improved patient experience and satisfaction
    - Cost savings/fewer wasted catheters
- Passive safety
  - Shown to reduce needlestick injuries by 50%–70% over nonpassive safety<sup>2</sup>
- Full needle coverage; not just the needle tip
  - Reduced risk of blood contact

**SurFlash® Safety Catheters Video**  
*Scan to see why SurFlash has it all!*



**Because every stick counts.**

References: 1. Data on file. 2. Tosini W, Ciotti C, Goyer F, et al. Needlestick injury rates according to different types of safety-engineered devices: results of a French multicenter study. *Infect Control Hosp Epidemiol.* 2010;31(4):402-407.



# Flashes of insight

## Based on a survey of 51 nurses:

- 98% of nurses think a successful first stick is very important for patients' satisfaction
  - 96% say it's important for their *own* satisfaction
  - 98% believe the need for a second attempt at IV insertion increases the patient's anxiety
- 94% of nurses are very interested in a product that is clinically proven to increase first-stick percentage by up to 25%
- 94% also prefer an IV catheter that provides a visual indicator when the catheter is in the vessel, not just when the needle tip enters the vessel
- 90% would prefer to minimize the risk of blood exposure during IV insertions without the need to apply venous compression

## We asked 47 nurses who currently use the market leading catheter brand to trial SurFlash Safety. After using SurFlash Safety:

- 72% agreed/strongly agreed that the SurFlash® feature gave them increased confidence in a First Stick Success
- 55% agreed/strongly agreed that they would like to convert to SurFlash®

### SurFlash® Safety I.V. Catheters

Packed: 50/box, 4 boxes/case (200)

Product Code	Gauge	Length	Flow Rate	O.D	I.D	PSI
SR*FNP1832	18	1¼"	100mL/min	1.3mm	0.95mm	325
SR*FNP2025	20	1"	65mL/min	1.1mm	0.80mm	
SR*FNP2032	20	1¼"	60mL/min	1.1mm	0.80mm	
SR*FNP2225	22	1"	35mL/min	0.9mm	0.60mm	
SR*FNP2232	22	1¼"	30mL/min	0.9mm	0.60mm	
SR*FNP2419	24	¾"	15mL/min	0.7mm	0.47mm	

## Here is how SurFlash® works:



Perform venipuncture at a low angle (15°) of insertion



The needle has been placed in the vessel as confirmed through the First Flash. The catheter, however, has not yet entered into the vessel. Continue advancing until you see the Second Flash along the entire length of the catheter.



The Second Flash between the catheter and the needle confirms proper catheter placement in the vessel. At this time you can advance the catheter forward off the needle into the vessel.



## I.V. Catheters & Accessories



These products have no components made of natural rubber latex.

(Large Photo)

### SURFLO® ETFE I.V. Catheters

An ultra-sharp double-bevel introducer needle plus a medical grade lubricant allow for easier penetration and smoother travel through tissue. Preview chamber in clear sure-grip hub gives immediate indication of proper placement. Flexible thinwall catheter with large inner diameter assures good blood flow. All this plus safe, easy-to-handle, tamper-evident packaging make SURFLO® I.V. Catheters a great clinical value.

**Packed: 50/box, 4 boxes/case (200)**

Product Code	Description
SR-OX1451CA	14G x 2"
SR-OX1632CA	16G x 1 1/4"
SR-OX1651CA	16G x 2"
SR-OX1664CA	16G x 2 1/2"
SR-OX1832CA	18G x 1 1/4"
SR-OX1851CA	18G x 2"
SR-OX1864CA	18G x 2 1/2"
SR-OX2025CA	20G x 1"
SR-OX2032CA	20G x 1 1/4"
SR-OX2051CA	20G x 2"
SR-OX2225CA	22G x 1"
SR-OX2419CA	24G x 3/4"

(Not Pictured)

### SurFlash® Polyurethane I.V. Catheters

- Visual confirmation of catheter placement during venipuncture occurs in a flash!
- Made of polyurethane, which makes it extremely flexible, kink-resistant and durable
- Provides medical staff with higher certainty of catheter placement due to unique flashback feature
- Improves visualization for difficult venipunctures

**Packed: 50/box, 4 boxes/case (200)**

Product Code	Description
SR*FF1451	14G x 2"
SR*FF1651	16G x 2"
SR*FF1664	16G x 2 1/2"
SR*FF1832	18G x 1 1/4"
SR*FF1851	18G x 2"
SR*FF1864	18G x 2 1/2"
SR*FF2025	20G x 1"
SR*FF2032	20G x 1 1/4"
SR*FF2051	20G x 2"
SR*FF2225	22G x 1"
SR*FF2419	24G x 3/4"



Terumo's Polyurethane I.V. Catheter enables quick and easy confirmation of placement in the vein.

With SurFlash, visual confirmation of catheter placement occurs due to a unique flashback feature. Flashback appears between the specially grooved needle and the catheter, providing medical staff with a higher certainty of proper catheter placement. The specially grooved needle also improves the ability to visualize flashback in patients where venipuncture is more difficult, and because SurFlash is made of polyurethane, which is firm at room temperature and softens at body temperature, patient comfort is enhanced, without compromising proper technique.



### SURFLO® Injection Plug

SURFLO Injection Plugs come in a choice of Luer Lock or Luer Slip. Large target area allows for easy needle penetration. The injection plugs have a tamper-resistant seal and easy to open packaging.

**Packed: 100/box, 10 boxes/case (1,000)**

Product Code	Description
SR-IP1	Luer Slip Injection Plug Luer Taper is 1.5 inches
SR-IP2	Luer Lock Injection Plug Luer Lock is 1.0 inches

# Frequently Asked Questions and Technical Support

## Who is the Sales Rep for my area?

Just log-on to [www.TerumoTMP.com](http://www.TerumoTMP.com) and select “Find Your Rep” from our homepage.

## How can I order Terumo products through a distributor?

Please see Terumo website: [www.TerumoTMP.com](http://www.TerumoTMP.com), and click on Customer Support to find a List of Authorized Terumo distributors.

## How can I obtain samples?

Need samples? We’ve now made it faster and easier for you to obtain samples and literature of our products through your local TMP rep. Just log-on to [www.TerumoTMP.com](http://www.TerumoTMP.com) and select “Find Your Rep” from our homepage.

## How can I obtain pricing?

You must check with your local distributor for pricing since our business is conducted through authorized distributors.

## How do I place an order?

Please contact your authorized distributor. To find a distributor, visit us at [www.TerumoTMP.com/Support](http://www.TerumoTMP.com/Support) to find a List of Authorized Terumo Distributors. Distributors should call Customer Administration for all questions related to orders and invoices: 800.888.3786

## What is the shelf life of Terumo Products?

Standard & Safety Syringes & Needles = 5 years  
Standard Insulin & Allergy Syringes = 5 years  
Injection Plugs = 2.5 years

## What’s the difference between SurFlash® & Surflo® IV Catheters?

SurFlash is an I.V. Polyurethane Catheter which allows for a visual confirmation of catheter placement due to its unique flashback feature. SURFLO is our regular ETFE I.V. Catheter. Both are radio-opaque and these products have no components made of natural rubber latex.

## Are all your Winged Needle sets made without natural rubber latex components, and are they DEHP free?

Yes, All Surshield® Safety Winged Needle Sets and SURFLO® Winged Infusion Sets are DEHP free and have no components made of natural rubber latex.

## Where can I get a Certificate of Analysis on products I have ordered?

Visit us at <http://www.terumomedical.com/Default.asp?dest=Certification/MainCertMenu.asp>, choose your product category and enter your lot number and receive a Certificate of Analysis.

## Where can I get a copy of the MSDS for Capiject®?

Visit us at [www.TerumoTMP.com/Support](http://www.TerumoTMP.com/Support) to obtain documentation for MSDS.

## Which Capiject® tubes are certified for lead testing?

Visit us at [www.TerumoTMP.com/Support](http://www.TerumoTMP.com/Support) to obtain documentation related to Lead Certification.

## How do I find out about Elemano™?

Contact your local distributor representative.

## What does the “Think green. Think Terumo.” Icon represent?

In 1999, Terumo Corporation developed a Basic Environmental Policy as part of our corporate mission of “Contributing to Society through Healthcare.” Since then, Terumo has engaged in a range of activities aimed at protecting the global environment. Terumo’s green products are the Elemano Portable Blood Pressure Monitor with PrecisePulse™ Technology, all Terumo Syringes, Surshield Safety Winged Blood Collection Sets, Surshield Safety Winged Infusion Sets, Surflo Blood Collection Sets and all Survet Hypodermic Syringes.

[www.TerumoTMP.com](http://www.TerumoTMP.com)

Ⓢ and TERUMO are trademarks owned by Terumo Corporation, Tokyo, Japan, and they are registered with the U.S. Patent & Trademark Office. SUR-VET, SURGUARD and SURSAVER are trademarks of Terumo Medical Corporation, Somerset, NJ. ELEMANO, SURFLO, SURSHIELD, SURFLASH, CAPIJECT and VENOJECT are registered trademarks of Terumo Corporation, Tokyo, Japan and they are registered with the U.S. Patent and Trademark Office. SampLok is a registered trademark of ITL Corporation, Canberra, Australia.

Accession # 10112013-2890

